

INSTALLATION MANUAL

DOOR MOLDINGS SET
AD PART #: F028E14

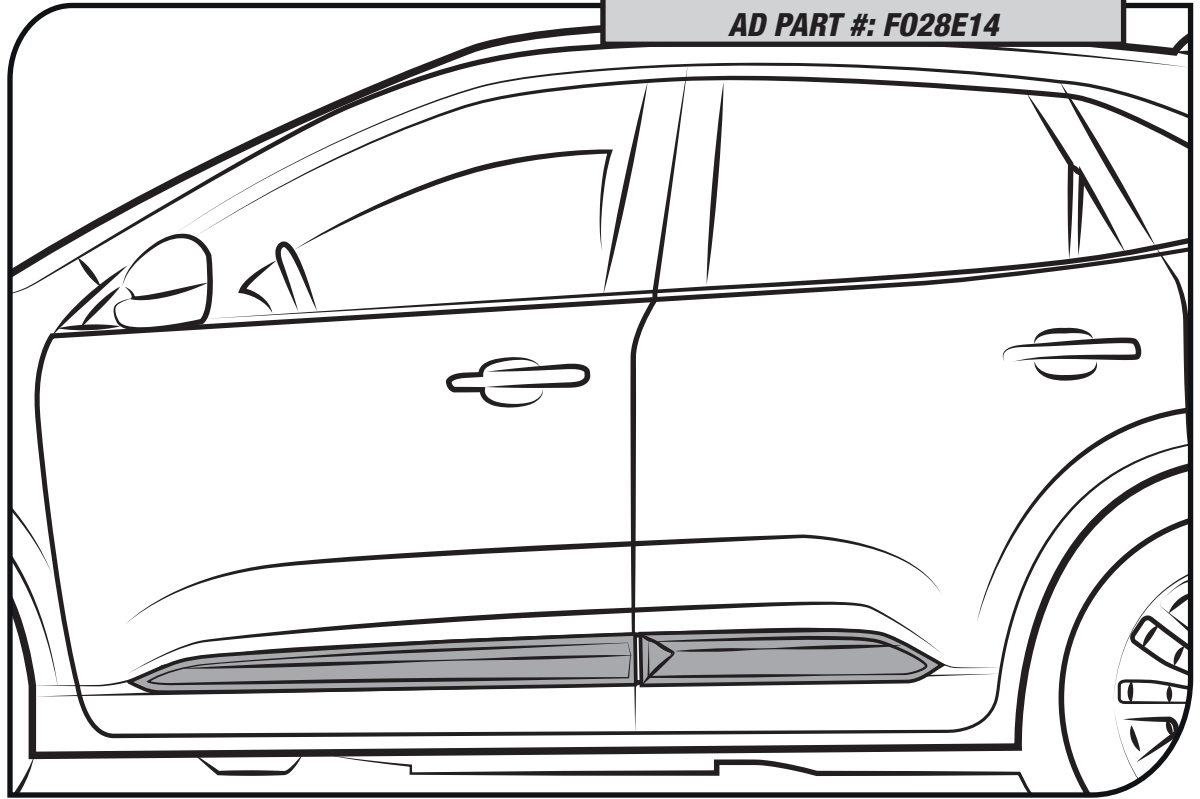

**READ CAREFULLY
BEFORE INSTALLATION**

**WASH BEFORE
INSTALLING**

**WE RECOMMEND
2 PERSONS FOR
INSTALLATION**



AFTER INSTALLING
DO NOT WASH CAR

24 hrs

TOOLS REQUIRED



CHECK LIST

ITEM	DESCRIPTION	DRAWING	AMOUNT
A	*VHB TAPE		N/A
B	POLYURETHANE ADHESIVE 310 ml		1 PC
C	ADHESION PROMOTER		2 PC

***ALREADY INSTALLED ON THE PART**

The ideal temperature range of the part and the vehicle when installing must be 16°C (60°F) to 40°C (104°F), this guarantees a correct assembly.

FRONT DOOR MOLDING

1 CLEAN



REMOVE ANY RISE AID OR GLOSS ENHANCERS RESIDUE

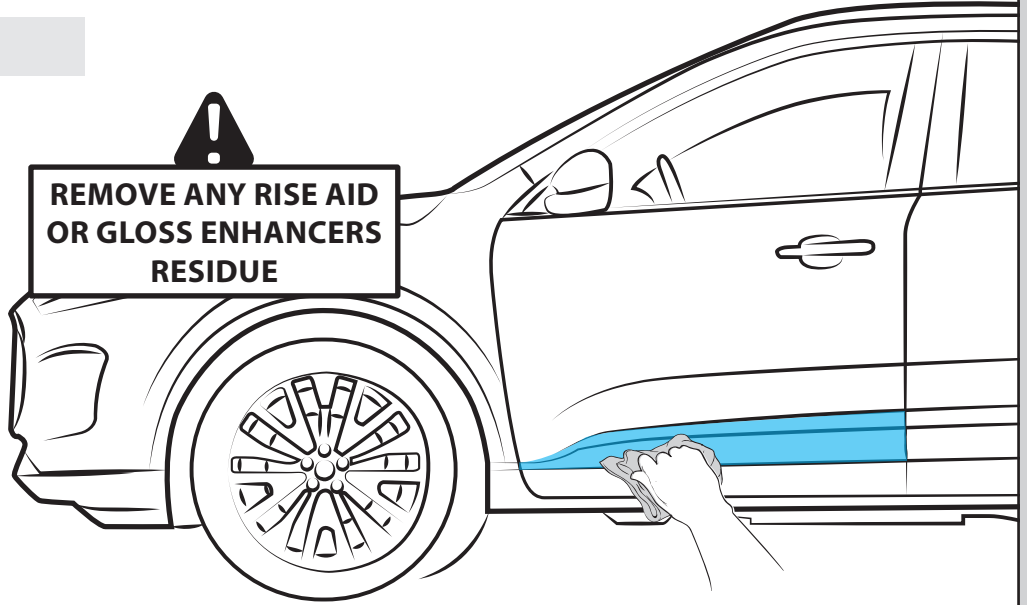

2 TEST FIT THE PART

VERIFY ASSEMBLY

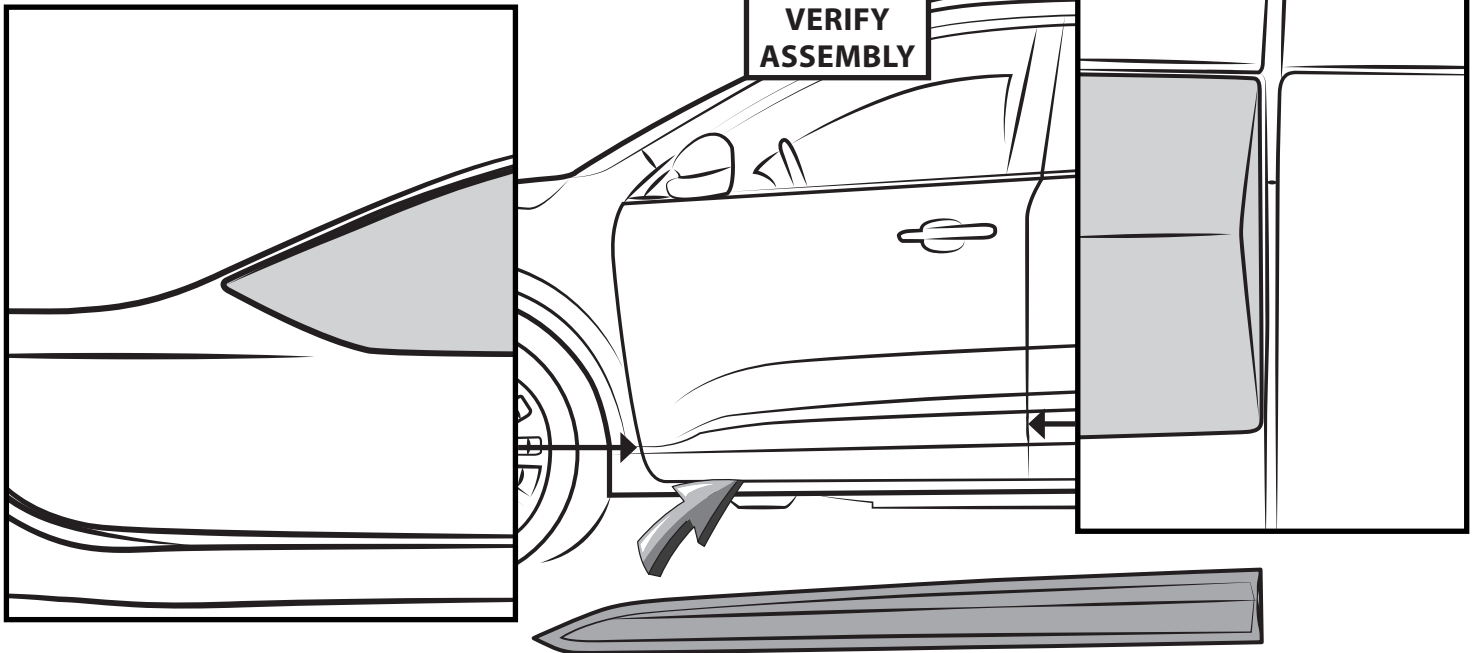

3 MARK

MASKING TAPE



4 REMOVE THE PART

WARM SURFACE WITH HEAT GUN IF SURFACE TEMPERATURE IS TOO COLD

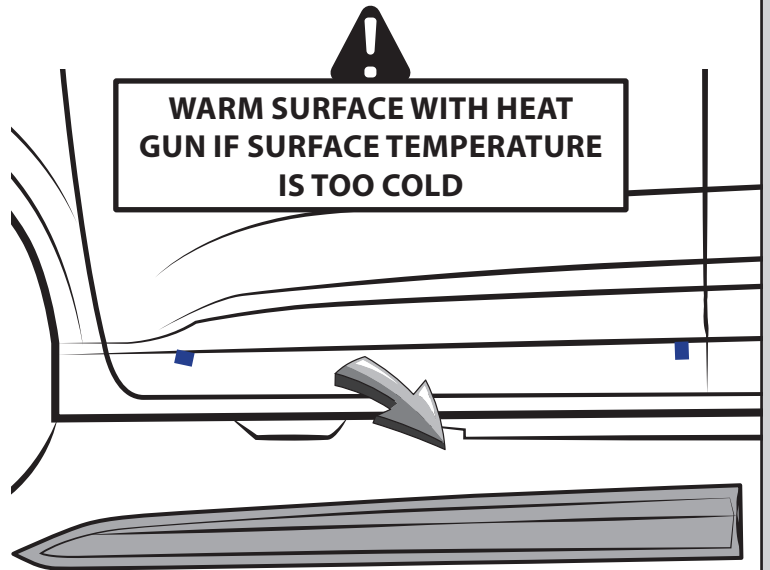

INSTALLATION MANUAL

5 APPLY ADHESION PROMOTER

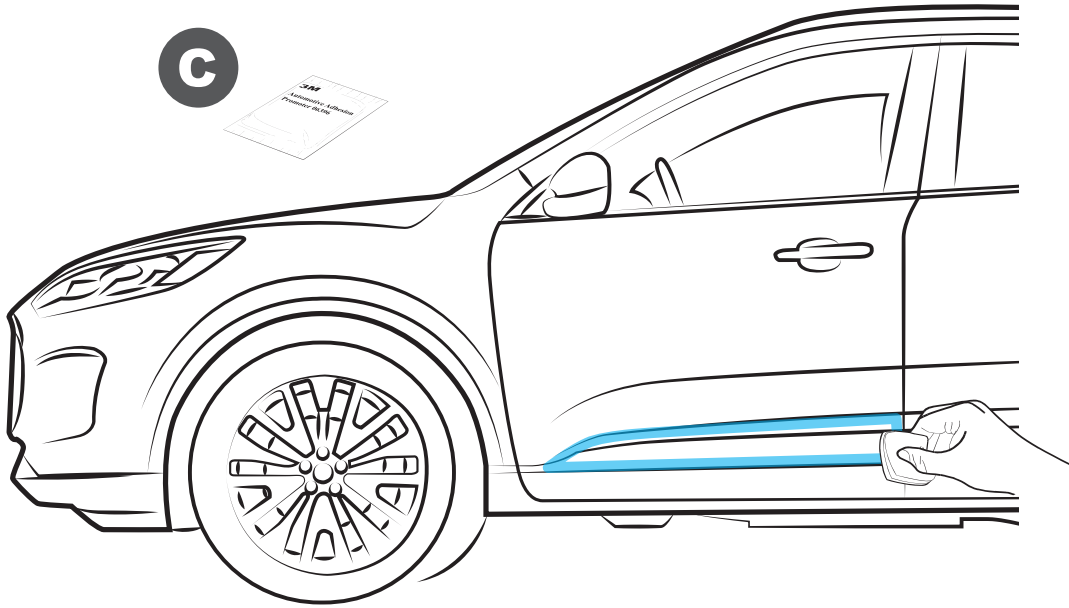

6 CLEAN THE ADHESIVE CHANNEL

! CLEAN THOROUGHLY TO ENSURE PROPER ADHESION

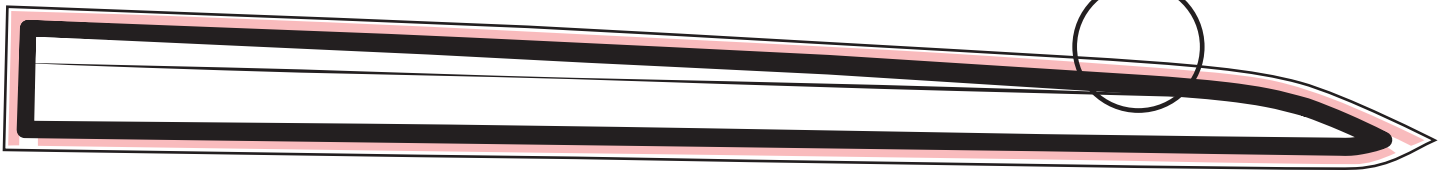
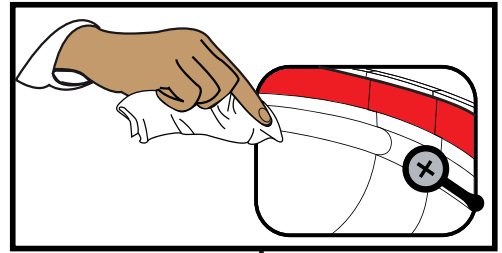

7 PEEL OFF THE LINER LEADS

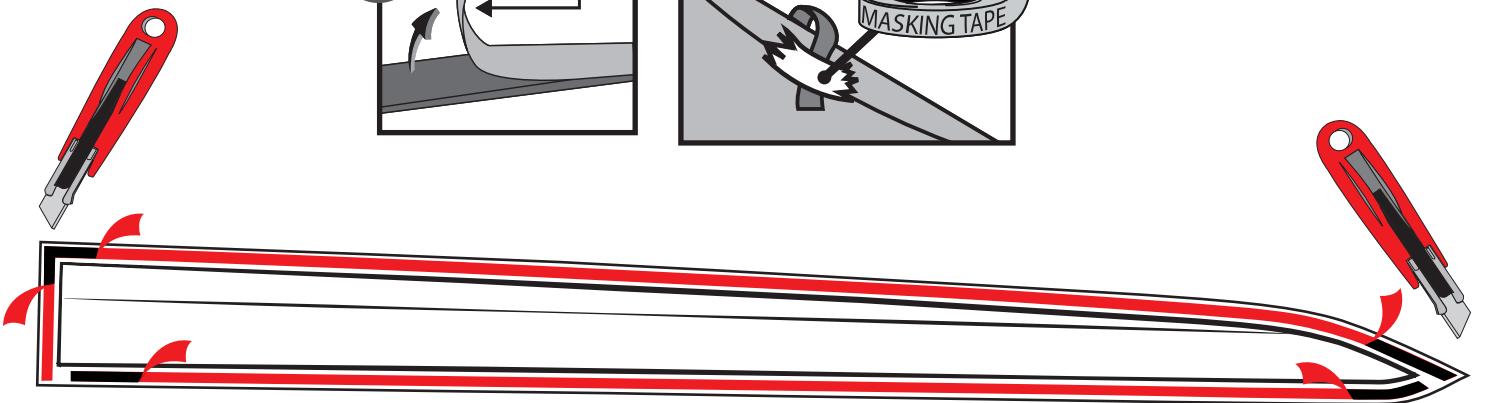
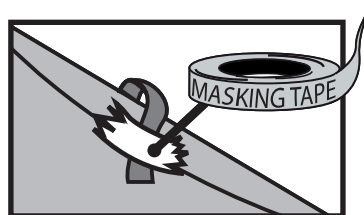
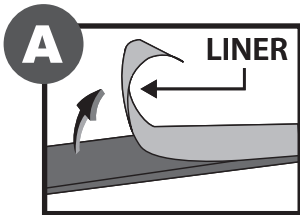

INSTALLATION MANUAL

8 APPLY POLYURETHANE ADHESIVE

POLYURETHANE ADHESIVE MUST NEVER TOUCH THE DOUBLE SIDED TAPE

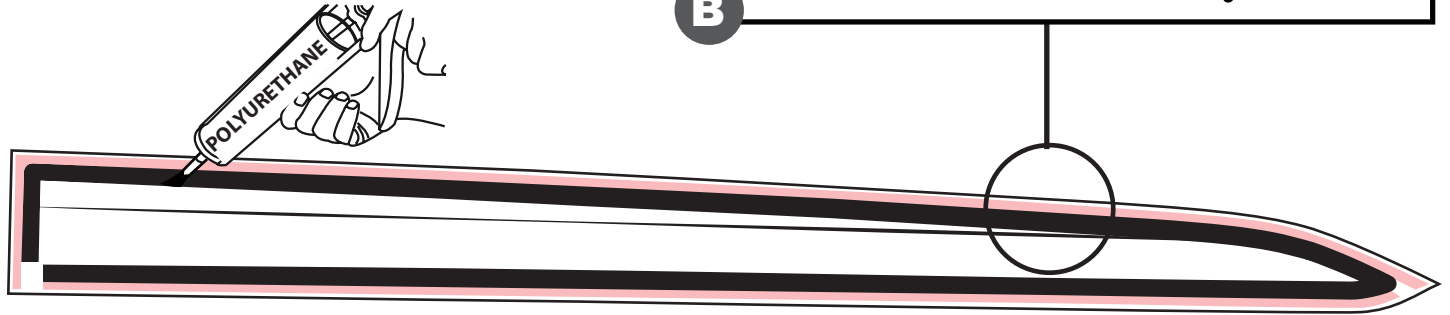
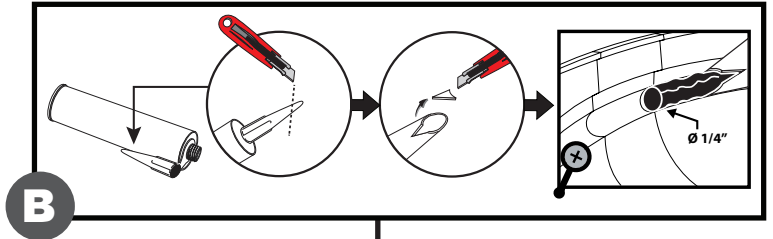

9 PLACE

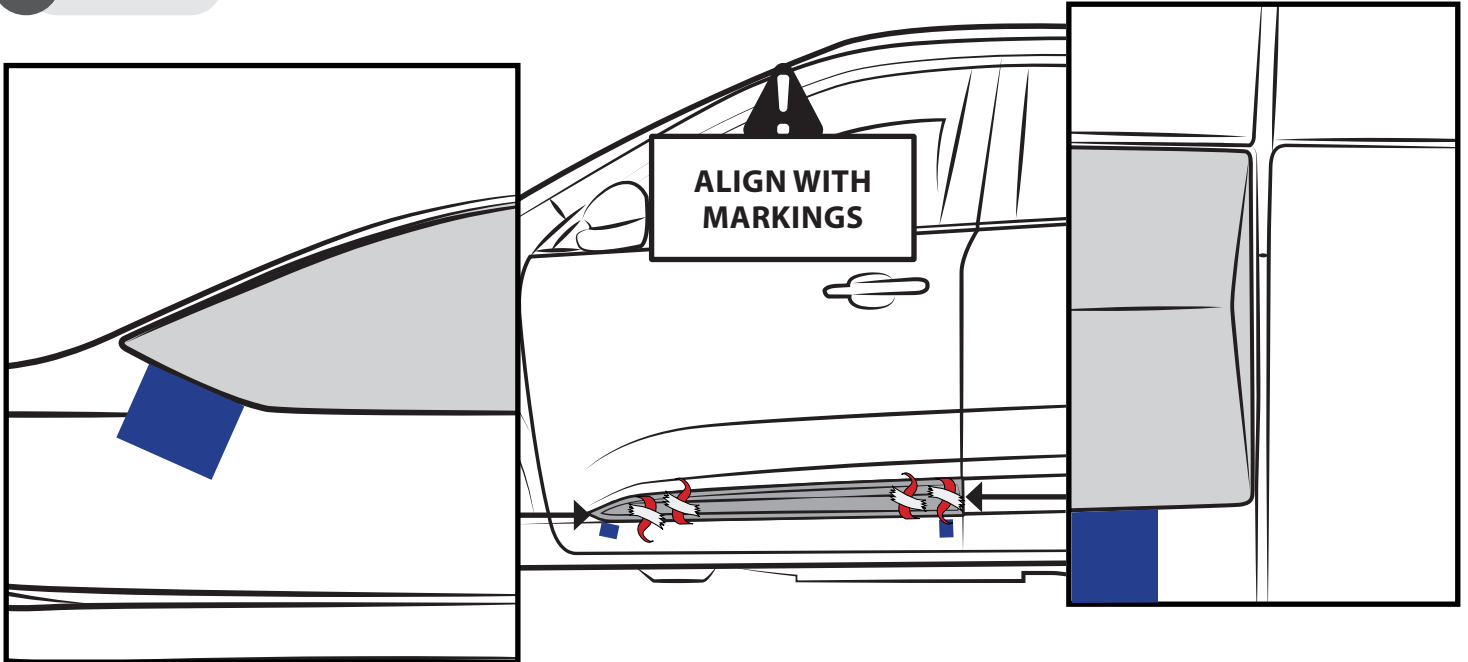

10 REMOVE LINER

APPLY LIGHT PRESSURE BEHIND THE TAPE TAB AS IT IS REMOVED TO ADHERE THE TAPE TO THE VEHICLE SURFACE

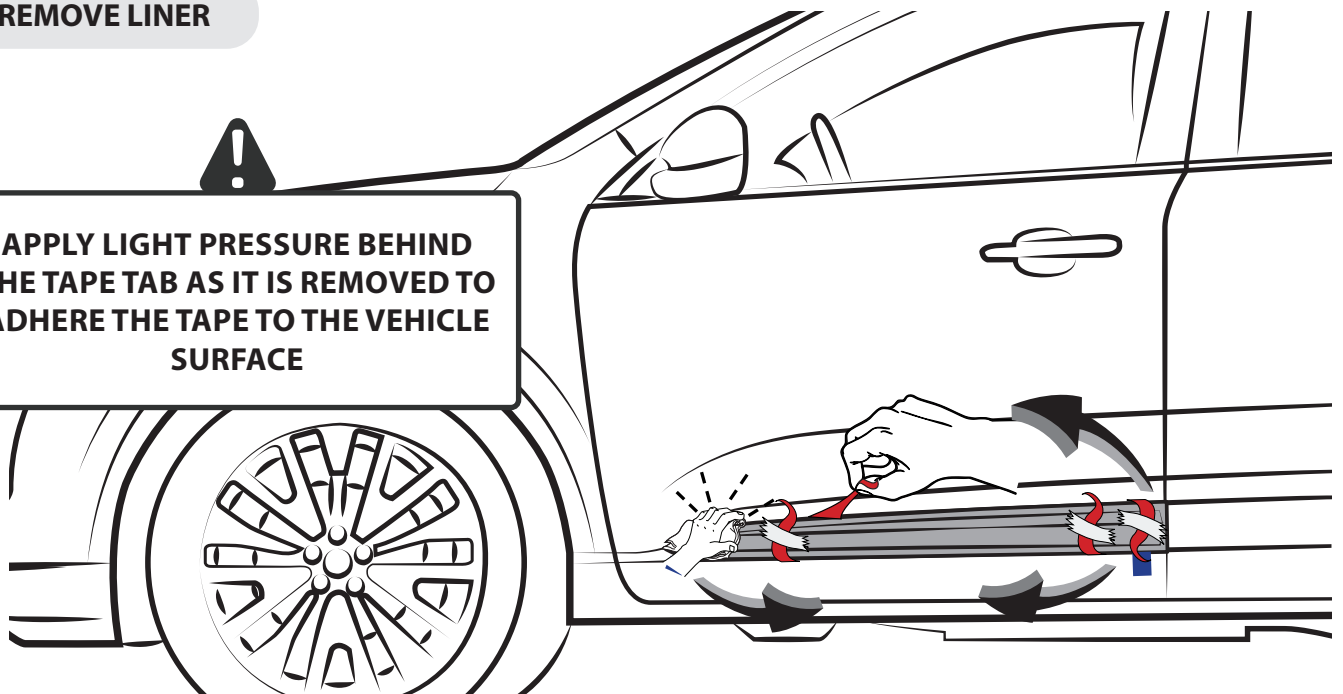

INSTALLATION MANUAL

11 PRESS FIRMLY

DURING APPLICATION, THE VEHICLE, ADD ON PARTS AND TAPE MUST BE AT OR ABOVE 16 °C OR 60 °F. A FULL SURFACE CONTACT BETWEEN TAPE AND SUBSTRATE IS IMPORTANT FOR GOOD ADHESION PERFORMANCE. CONTACT IS ACHIEVED BY APPLYING PRESSURE. IN PRACTICE A PRESSURE BETWEEN 40 AND 50 N/CM² IS USUALLY NEEDED.

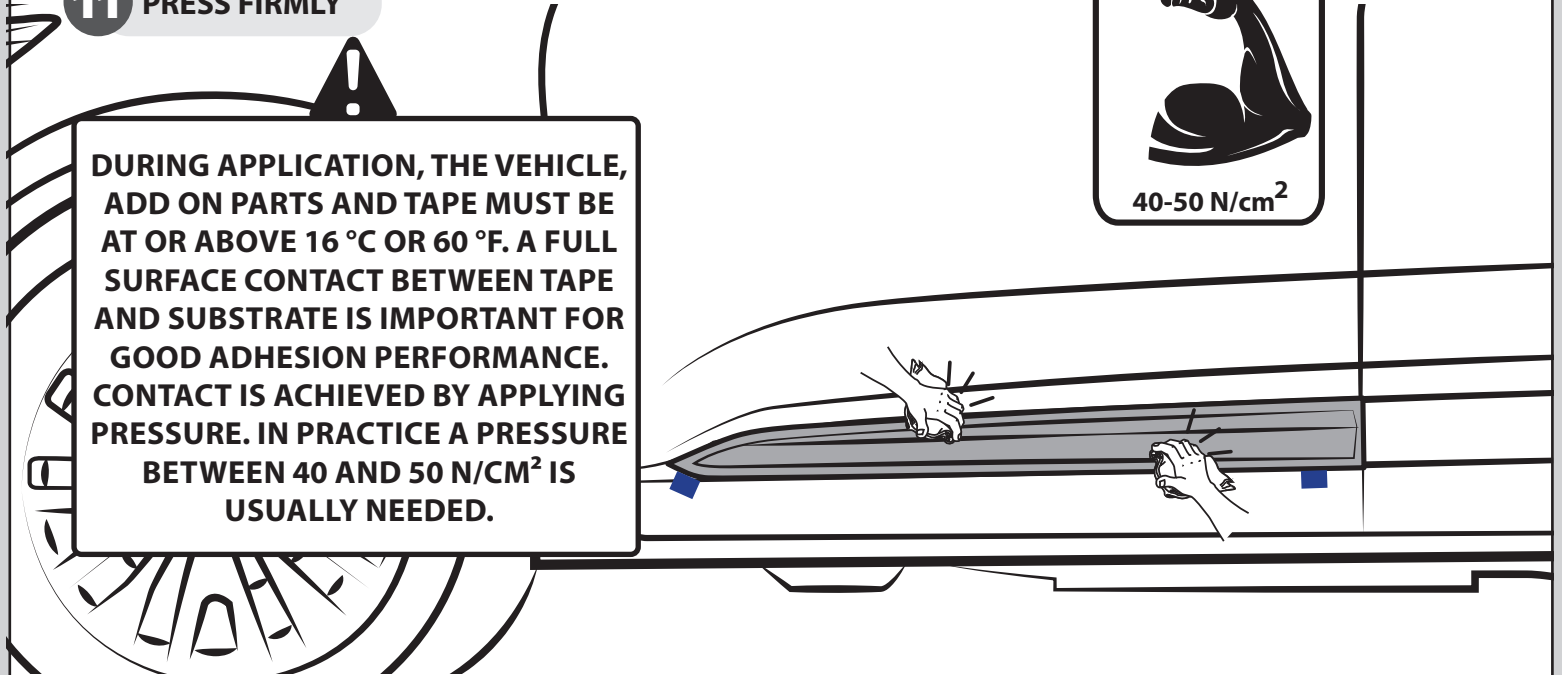

12 CLEAN

REPEAT ALL STEPS FOR RH SIDE



REMOVE MASKING TAPE



REAR DOOR MOLDING

1 CLEAN

REMOVE ANY RISE AID OR GLOSS ENHANCERS RESIDUE

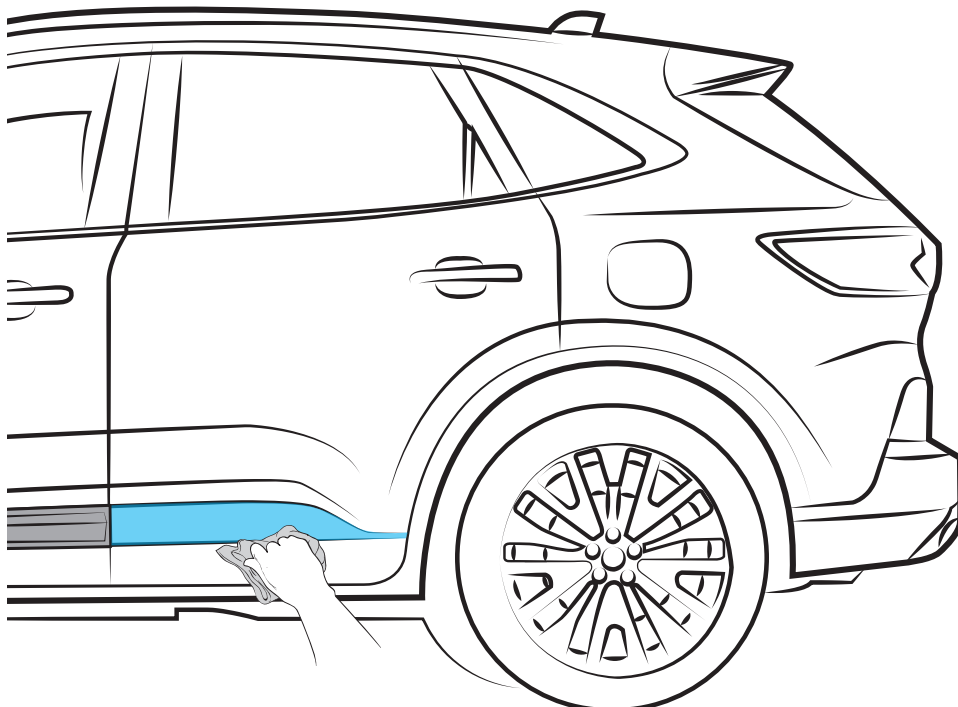

INSTALLATION MANUAL

2 TEST FIT THE PART

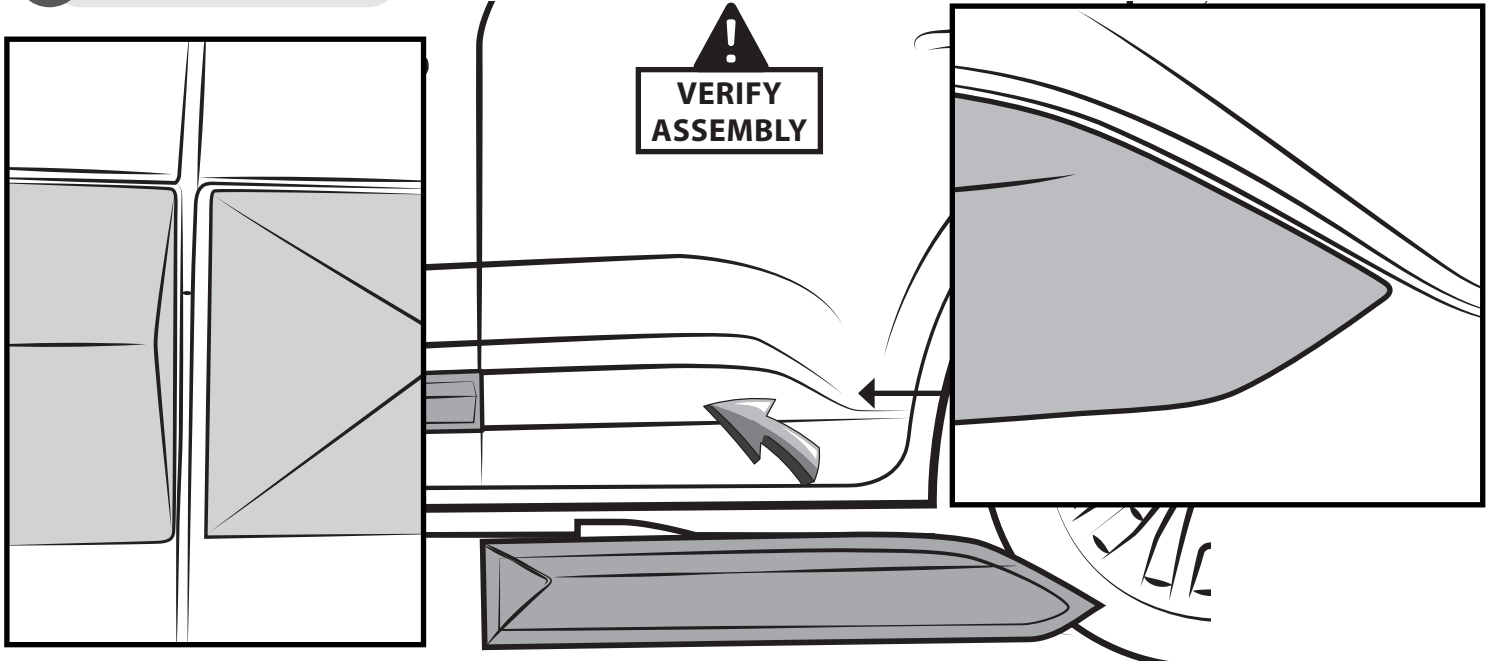

3 MARK

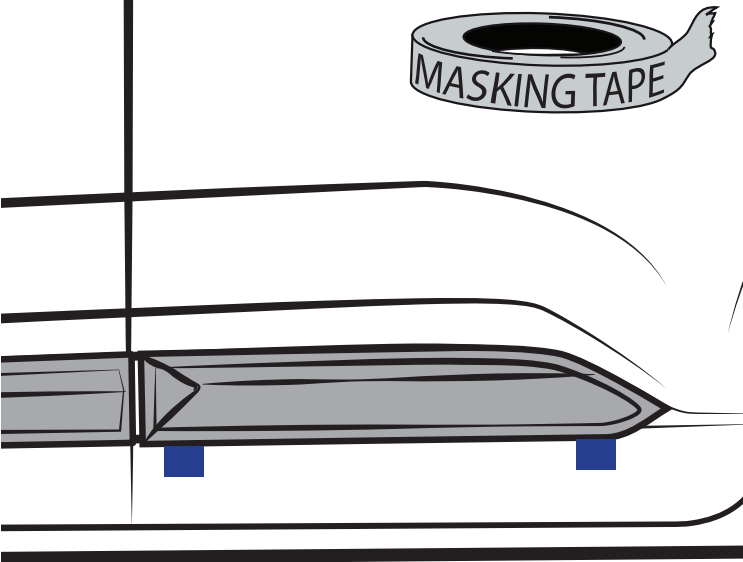

4 REMOVE

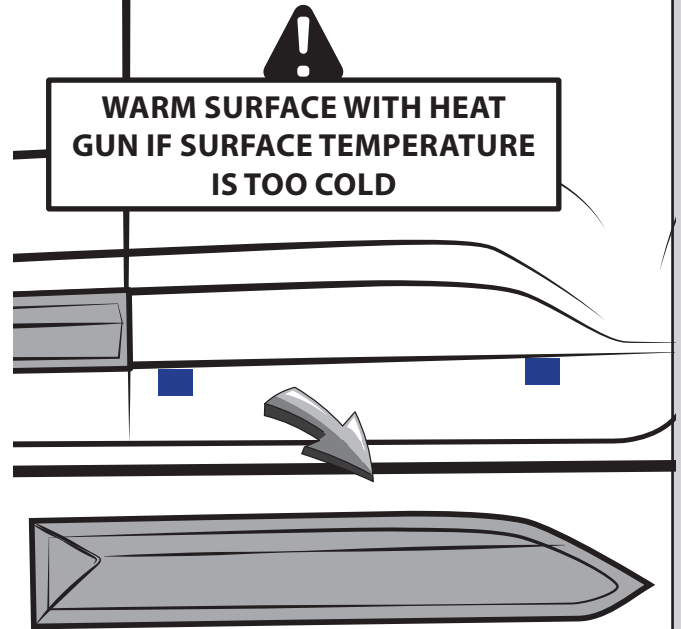

5 APPLY ADHESION PROMOTER

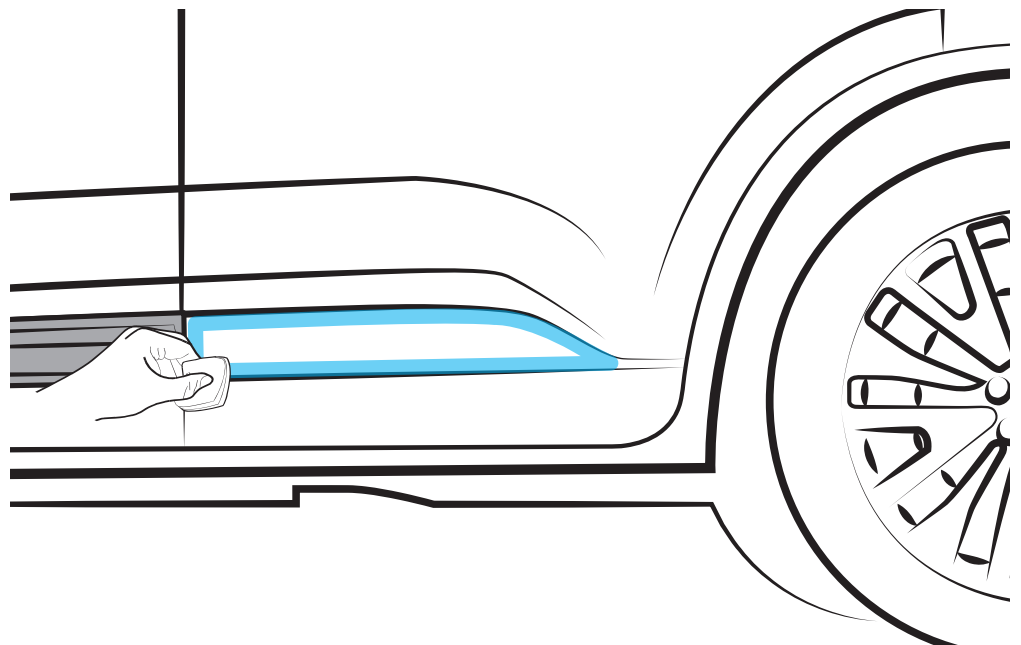

INSTALLATION MANUAL

6 CLEAN ADHESIVE CHANNEL

CLEAN THOROUGHLY TO ENSURE PROPER ADHESION

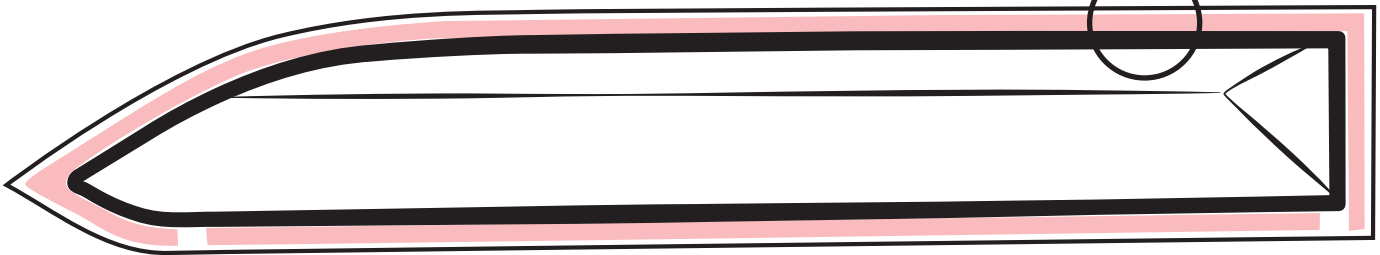
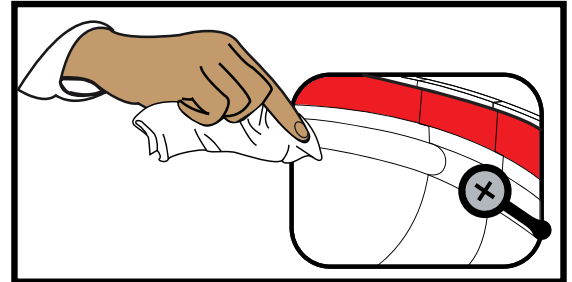

7 PEEL OFF THE LINERS LEADS

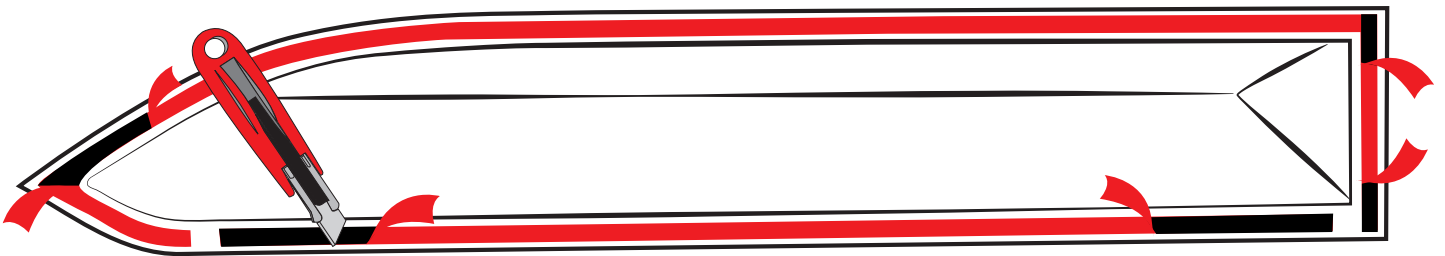
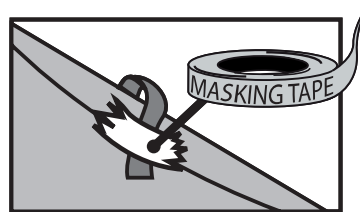
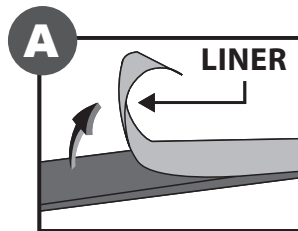

8 APPLY POLYURETHANE ADHESIVE

CLEAN THOROUGHLY TO ENSURE PROPER ADHESION

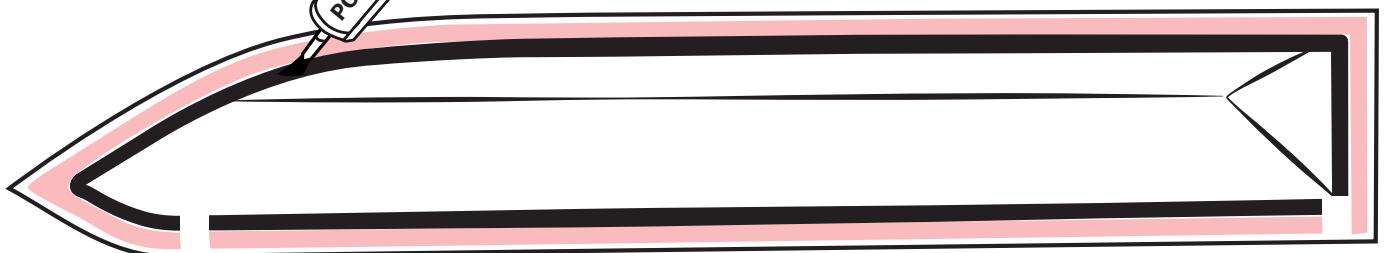
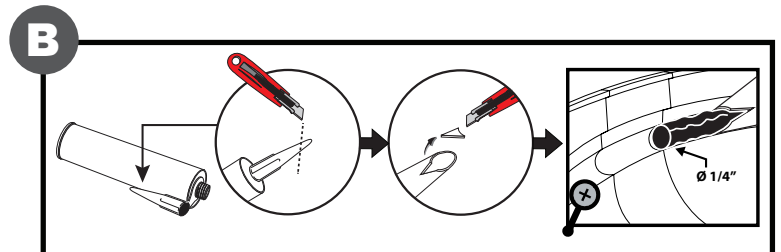

9 PLACE

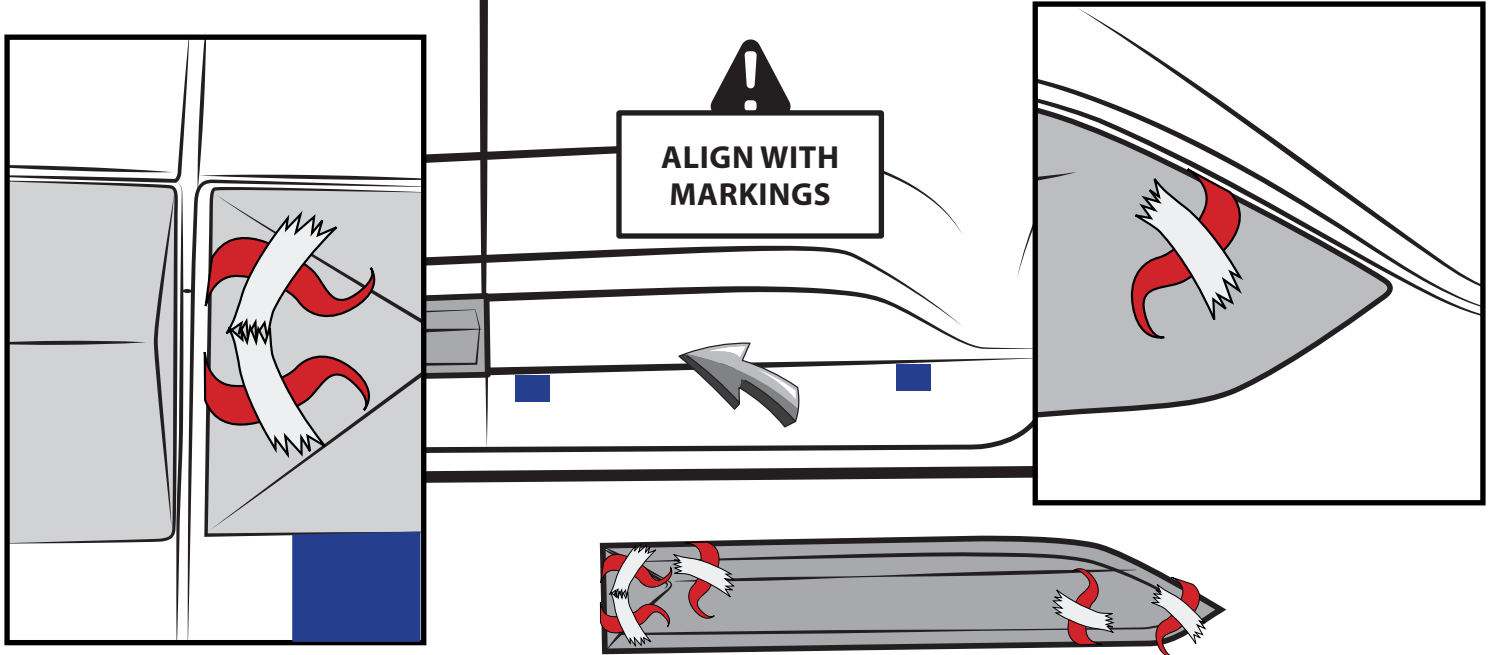

10 REMOVE LINER

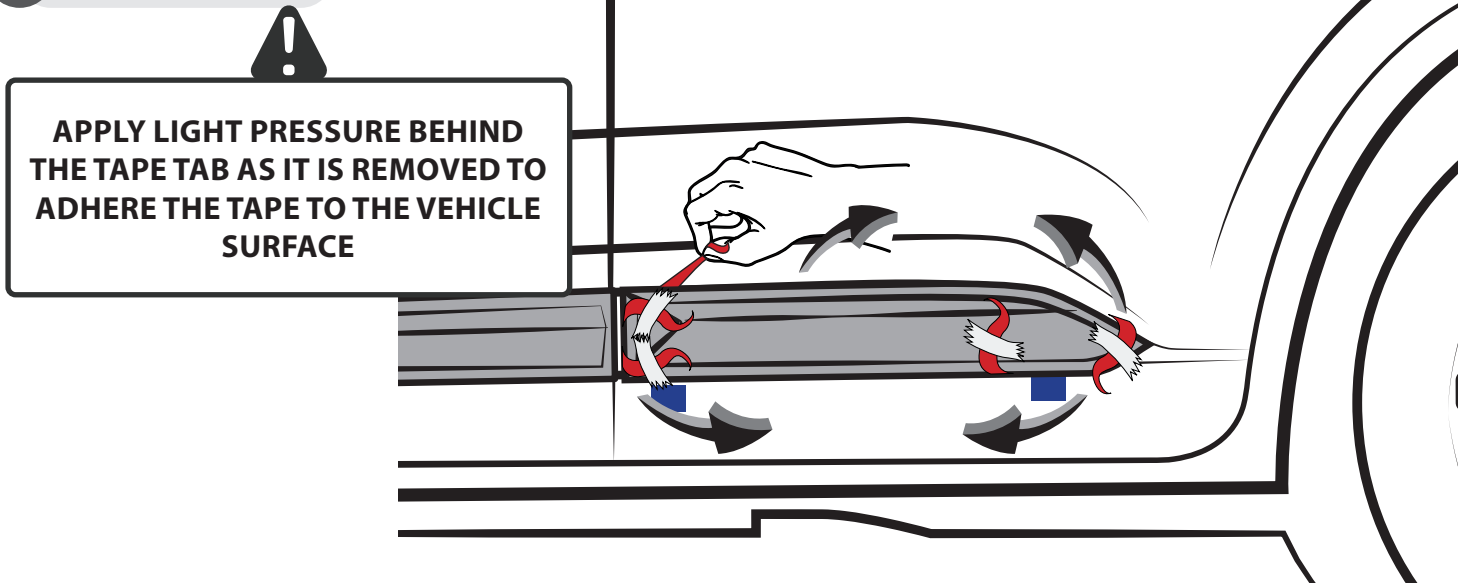

11 PRESS FIRMLY

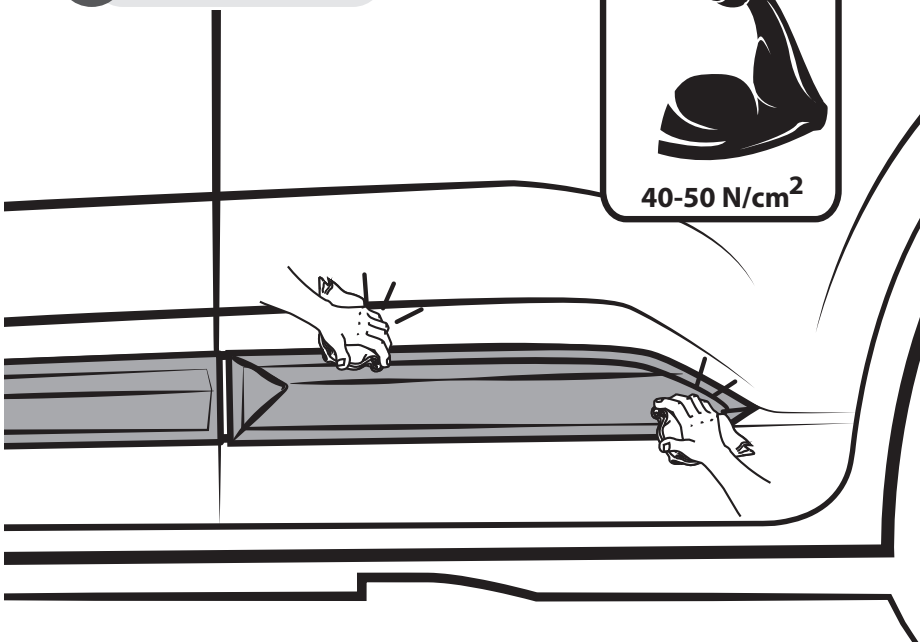

DURING APPLICATION, THE VEHICLE, ADD ON PARTS AND TAPE MUST BE AT OR ABOVE 16 °C OR 60 °F. A FULL SURFACE CONTACT BETWEEN TAPE AND SUBSTRATE IS IMPORTANT FOR GOOD ADHESION PERFORMANCE. CONTACT IS ACHIEVED BY APPLYING PRESSURE. IN PRACTICE A PRESSURE BETWEEN 40 AND 50 N/CM² IS USUALLY NEEDED.

INSTALLATION MANUAL

12 CLEAN

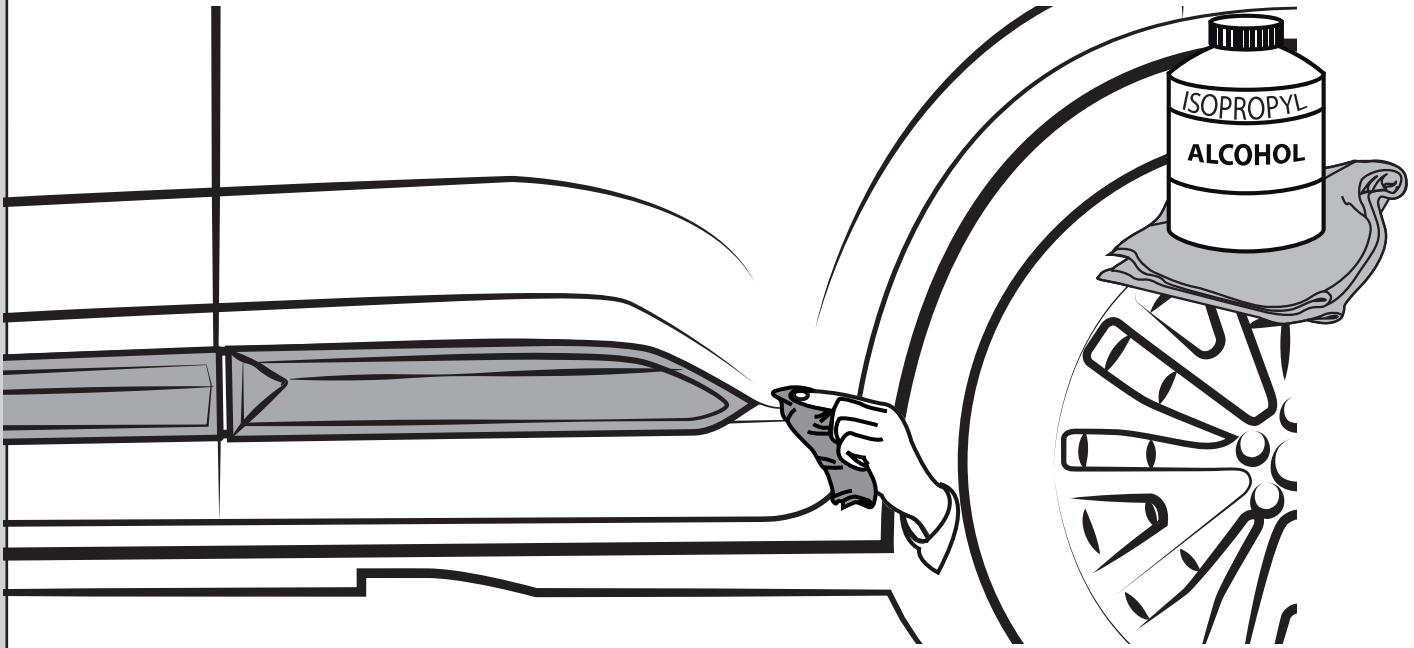

**REPEAT ALL STEPS
FOR RH SIDE**

